

- ▶ VDE-AR-N 4110; VDE-AR-N 4120
- ▶ G99 Issue 1 Amendment 6
- ▶ Improved frequency and ROCOF precision
- ▶ Improved design of the PC tools
- ▶ Configurable SCADA protocols:
- ▶ Modbus, Profibus, IEC 60870-5-103/-104, DNP3

All HighPROTEC devices have been type tested and certified by KEMA Laboratories (IEC 60255-1:2009).

APPLICATION

The MRU4 is a protection relay which uses the latest Dual-Core-Processor Technology to provide precise and reliable protective functions and is very easy to operate.

It is designed to protect electrical equipment from dangerous voltage fluctuations.

For example protection against under voltages caused by mains shortcircuits, or overvoltages due to load shedding or failure of a generator voltage controller.

Its compact design makes the MRU4 ideal for installation within the LV terminal compartments of compact SF6-insulated MV systems.

The protection functions of the MRU4 have been adapted to comply with the requirements of the VDE-AR-N-4110:2018.

ALL INCLUSIVE:

- ▶ All protection features without extra charge
- ▶ Parameter setting and evaluation software
- ▶ Disturbance record analysis software

COMPREHENSIVE FREQUENCY PROTECTION PACKAGE

Each of the six elements can be used as:

- ▶ $f <$ or $f >$ (over- and underfrequency supervision)
- ▶ df/dt (ROCOF) – Rate of change of frequency
- ▶ ($f <$ and df/dt) or ($f >$ and df/dt)
Combination of over-, under- and rate of change of frequency (ROCOF)
- ▶ ($f <$ and DF/DT) or ($f >$ and DF/DT)
Combination of over-, under- and increase of frequency
- ▶ Delta Phi (Vector surge)

SIX ELEMENTS VOLTAGE PROTECTION

- ▶ Under- and overvoltage
- ▶ Programmable time dependent under-voltage tripping characteristic

SIX ELEMENTS VOLTAGE ASYMMETRY SUPERVISION

- ▶ Under- and overvoltage in positive phase sequence system, overvoltage in negative phase sequence system

ADDITIONAL HIGHLIGHTS

- ▶ Two Elements Residual Voltage Protection VE>
- ▶ Flexible Fourth Voltage measuring input

- 2 elements VE> or VX (for Synchro-check)
- ▶ Sliding-Mean-Square Supervision, adjustable (VDE-AR 4105)
- ▶ FRT (LVRT), adjustable LVRT-profiles, optionally AR-controlled
- ▶ Synchrocheck: Generator-to-System, System-to-System, options to switch onto dead bus bars
- ▶ Power Quality: THD-protection

SUPERVISION

- ▶ Voltage transformer supervision
- ▶ Trip circuit supervision
- ▶ CBF via position indicators

RECORDERS

- ▶ Disturbance recorder: 120 s non volatile
- ▶ Fault recorder: 20 faults
- ▶ Event recorder: 300 events
- ▶ Trend recorder: 4000 non volatile entries

PC TOOLS

- ▶ Setting and analyzing software
Smart view for free
- ▶ Including page editor to design own Control pages
- ▶ SCADApt to re-assign datapoints for Retrofit projects: Modbus, Profibus, IEC 60870-5-103/-104

CONTROL

- ▶ 1 breaker
- ▶ Breaker wear



COMMISSIONING SUPPORT

- ▶ USB connection
- ▶ Customizable Display (Single-Line)
- ▶ Customizable Inserts
- ▶ Copy and compare parameter sets
- ▶ Configuration files are convertible
- ▶ Forcing and disarming of output relays
- ▶ Integrated fault simulator
- ▶ Graphical display of tripping characteristics
- ▶ 8 languages selectable within the relay

COMMUNICATION OPTIONS

- ▶ IEC 61850
- ▶ Profibus DP
- ▶ Modbus RTU and/or Modbus TCP
- ▶ IEC 60870-5-103
- ▶ IEC 60870-5-104
- ▶ DNP 3.0 (RTU, TCP, UDP)
- ▶ SCADApt

CYBER SECURITY

- ▶ Menu for the activation of security settings (e. g. hardening of interfaces)
- ▶ Security Logger
- ▶ Centralized Security Logs (Syslog)
- ▶ Encrypted Connection Smart view – Device
- ▶ Device specific certificates (No man in the middle attacks)

LOGIC

- ▶ Up to 80 logic equations for protection, control and monitoring

TIME SYNCHRONISATION

- ▶ SNTP, IRIG-B00X, Modbus, DNP 3.0, IEC 60870-5-103/-104

FUNCTIONAL OVERVIEW

| | Elements | ANSI |
|---|----------|------------|
| Protective Functions | | |
| V>, V<, V<(t) under- and overvoltage protection, programmable time dependent undervoltage tripping characteristic | 6 | 27, 59 |
| FRT (optional coordination with AR-feature) | 1 | 27 (t, AR) |
| Synchronism check | 1 | 25 |
| Each of the six frequency protection elements can be used as: | 6 | |
| → f< or f> (over- and under frequency supervision) | | 81U/O |
| → df/dt rate of change of frequency (ROCOF) | | 81R |
| → (f< and df/dt) or (f> and df/dt) combination of over-, under- and rate of change of frequency (ROCOF) | | |
| → (f< and DF/DT) or (f> and DF/DT) combination of over-, under- and increase of frequency | | 78 |
| → Delta Phi (Vector surge) | | |
| VE, residual voltage protection | 2 | 59N |
| Voltage asymmetry supervision (V012) | | |
| V1, under and overvoltage in positive phase sequence system | 6 | 47 |
| V2, overvoltage in negative phase sequence system | | |
| ExP, External alarm and trip functions | 4 | |
| 10-Minutes-Mean-Square-Sliding Supervision: adjustable according to VDE-AR 4105 | | |
| Control and Logic | | |
| Control: Position indication, supervision time management and interlockings for 1 breaker | | |
| Logic: Up to 80 logic equations, each with 4 inputs, selectable logical gates, timers and memory function | | |
| Supervision Functions | | |
| CBF, circuit breaker failure protection (via position indicators) | 1 | 62BF |
| TCS, trip circuit supervision | 1 | 74TC |
| VTS, voltage transformer supervision by comparing phase and residual voltages | 1 | 60FL |
| VTS, fuse failure protection via digital input | 1 | 60FL |
| THD supervision | | |

DIMENSIONS OF THE DEVICE VARIANT FOR DOOR MOUNTING

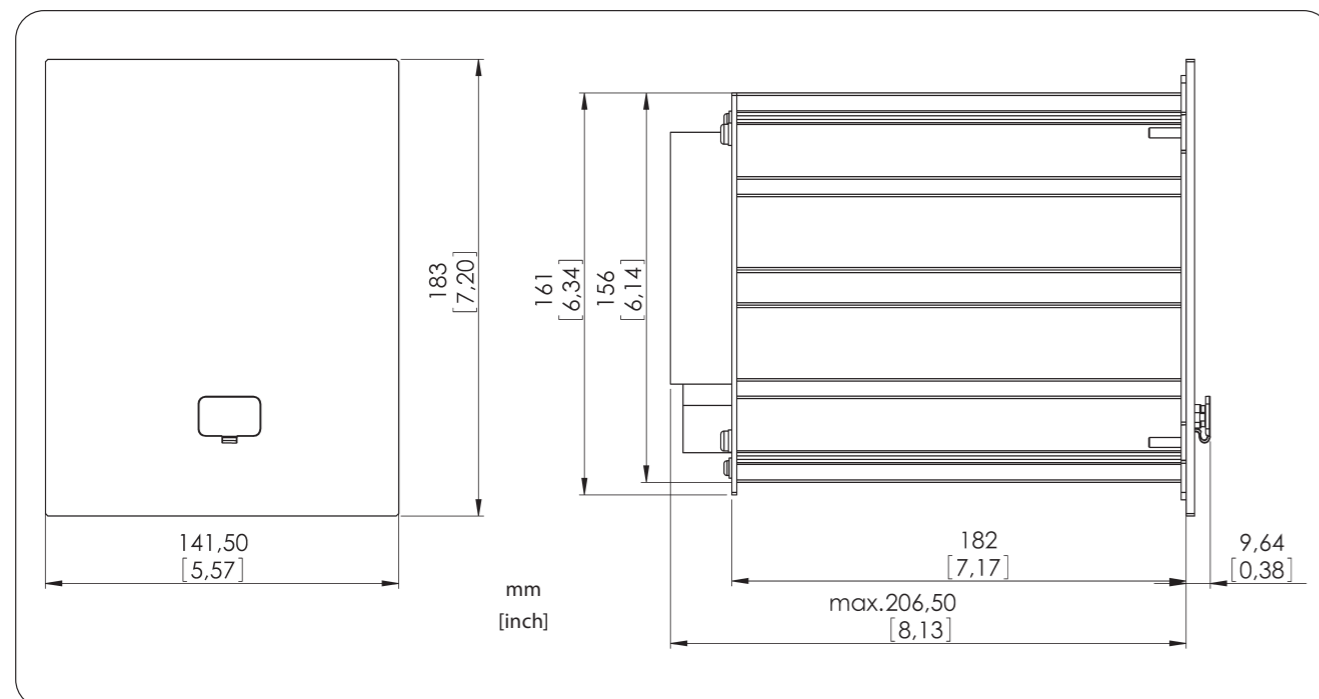

FUNCTIONAL OVERVIEW IN ANSI / IEEE C37.2 FORM

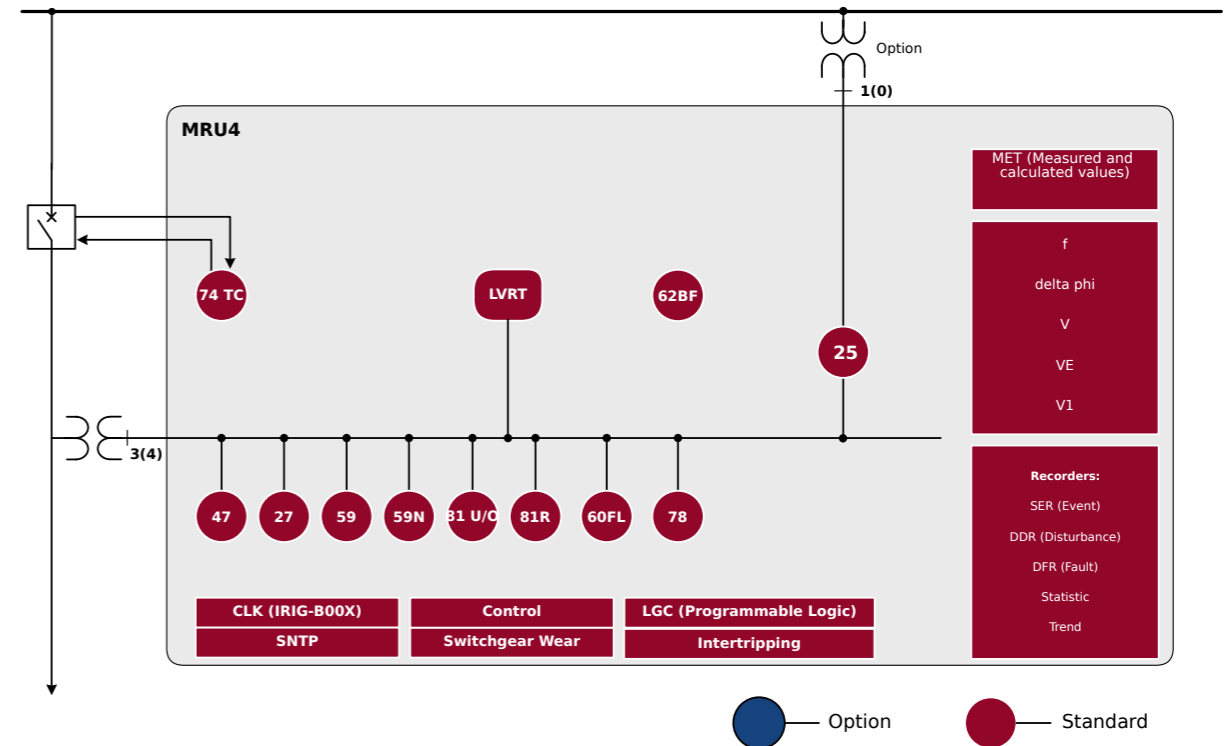

APPROVALS / STANDARDS

- certified regarding UL508 (Industrial Controls)
- certified regarding CSA-C22.2 No. 14 (Industrial Controls)
- certified by EAC (Eurasian Conformity)
- Type tested and certified by KEMA Laboratories in accordance with the complete type test requirements of IEC 60255-1:2009.
- Component certificate regarding the German grid code standard VDE-AR-N 4110 (2018-11)
- Component certificate regarding the German grid code standard VDE-AR-N 4120 (2018-11)
- KESCO 통일성 선언서 (Declaration of Identity)

Complies with "Engineering Recommendation G99 Issue 1 Amendment 6 - March 2020".
 Complies with IEEE 1547-2003.
 Amended by IEEE 1547a-2014.
 Complies with ANSI C37.90-2005.

CONNECTIONS (EXAMPLE)

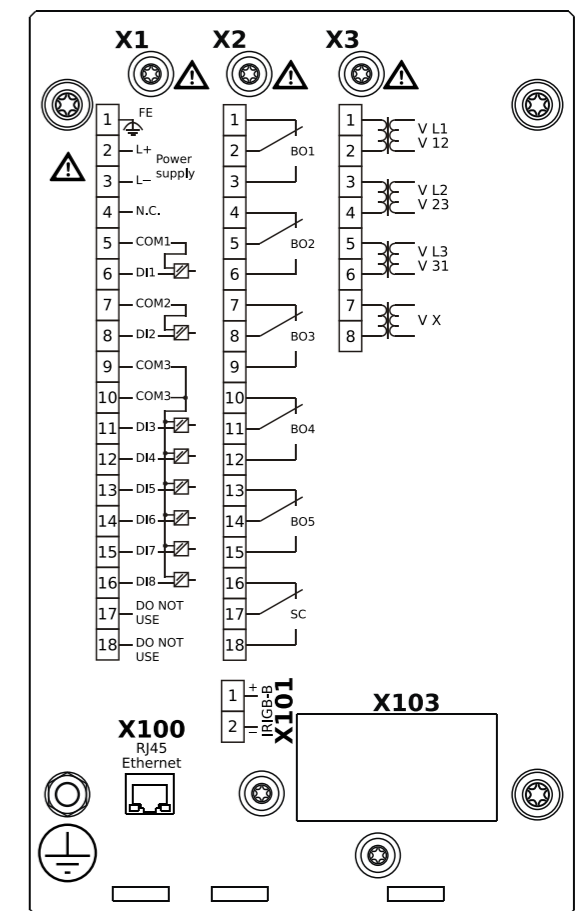

ORDER FORM MRU4

| Voltage and Frequency supervision | | | | MRU4 | -2 | A | 0 | | | |
|---|-----------------------------|----------------|----------------------|------|----|---|---|--|--|----|
| Version 2 with USB, enhanced communication and user options | | | | | | | | | | |
| Digital Inputs | Binary output relays | Housing | Large display | | | | | | | |
| 8 | 6 | B1 | - | | | | | | | |
| Hardware variant | | | | | | | | | | |
| Standard | | | | | | | | | | |
| Housing and mounting | | | | | | | | | | |
| Housing suitable for door mounting | | | | | | | | | | A |
| Housing suitable for 19" rack mounting ** | | | | | | | | | | B |
| Communication protocol | | | | | | | | | | |
| Without protocol | | | | | | | | | | A |
| Modbus RTU, IEC 60870-5-103, DNP3.0 RTU <i>RS485/terminals</i> | | | | | | | | | | B* |
| Modbus TCP, DNP 3.0 TCP/UDP, IEC 60870-5-104 <i>Ethernet 100 MB/RJ45</i> | | | | | | | | | | C* |
| Profibus-DP <i>optic fiber/ST-connector</i> | | | | | | | | | | D* |
| Profibus-DP <i>RS485/D-SUB</i> | | | | | | | | | | E* |
| Modbus RTU, IEC 60870-5-103, DNP 3.0 RTU <i>optic fiber/ST-connector</i> | | | | | | | | | | F* |
| Modbus RTU, IEC 60870-5-103, DNP 3.0 RTU <i>RS485/D-SUB</i> | | | | | | | | | | G* |
| IEC 61850, Modbus TCP, DNP 3.0 TCP/UDP, IEC 60870-5-104 <i>Ethernet 100MB/RJ45</i> | | | | | | | | | | H* |
| IEC 60870-5-103, Modbus RTU, DNP 3.0 RTU <i>RS485/terminals</i> | | | | | | | | | | I* |
| Modbus TCP, DNP 3.0 TCP/UDP, IEC60870-5-104 <i>Ethernet 100 MB/RJ45</i> | | | | | | | | | | K* |
| IEC 61850, Modbus TCP, DNP 3.0 TCP/UDP, IEC 60870-5-104 <i>Optical Eth. 100MB/LC duplex connector</i> | | | | | | | | | | L* |
| Modbus TCP, DNP 3.0 TCP/UDP, IEC 60870-5-104 <i>Optical Ethernet 100MB/LC duplex connector</i> | | | | | | | | | | T* |
| IEC 60870-5-103, Modbus RTU, DNP 3.0 RTU <i>RS485/terminals</i> | | | | | | | | | | |
| IEC 61850, Modbus TCP, DNP 3.0 TCP/UDP, IEC60870-5-104 <i>Ethernet 100 MB/RJ45</i> | | | | | | | | | | |
| Harsh Environment Option | | | | | | | | | | |
| None | | | | | | | | | | A |
| Conformal Coating | | | | | | | | | | B |
| Special Standards-Related Packages | | | | | | | | | | |
| None | | | | | | | | | | |
| G99 Type-Tested Variant (based on a special EREC-G99-adapted Release 3.6) | | | | | | | | | | +G |
| Available menu languages (in every device) | | | | | | | | | | |
| English / German / Spanish / Russian / Polish / Portuguese / French / Romanian | | | | | | | | | | |

* Within every communication option only one communication protocol is usable.
Smart view can be used in parallel via the Ethernet interface (RJ45).

The parameterizing- and disturbance analyzing software Smart view is included in the delivery of HighPROTEC devices.

| | |
|--|---|
| Voltage inputs | 4 (0 ... 800 V) |
| Digital Inputs | Switching thresholds adjustable via software |
| Power supply | Wide range power supply 24 V _{DC} - 270 V _{DC} / 48 V _{AC} - 230 V _{AC} (-20/+10%) |
| Terminals | All terminals plug type |
| Type of enclosure (Front) | IP54 |
| Dimensions of housing (W x H x D) | 19" flush mounting: 141.5 mm x 173 mm x 208 mm 5 571 in. x 6 811 in. x 8 228 in. Door mounting: 141.5 mm x 183 mm x 208 mm 5 571 in. x 7 205 in. x 8 228 in. |
| Weight (max. components) | approx. 2.4 kg / 5.29 lb |

19 " Variants Available! **



<https://docs.SEGelectronics.de/hpt-2>

CONTACT:

SEG Electronics GmbH
Krefelder Weg 47
D-47906 Kempen (Germany)
P.O.Box 10 07 55
D-47884 Kempen (Germany)

Sales
Telephone
+49 (0) 21 52 145 331
Telefax
+49 (0) 21 52 145 354
E-Mail
sales@SEGelectronics.de

Service & Support
Telephone
+49 (0) 21 52 145 614
Telefax
+49 (0) 21 52 145 354
E-Mail
support@SEGelectronics.de

For distributor information, visit
<http://www.SEGelectronics.de>

For more information please contact: